

## Specifications

- **Open-loop stroke: 750  $\mu\text{m}$  @ 150V (fixed-free)**
    - \*Tolerance value: 600~900  $\mu\text{m}$
  - **Operating voltage: -20 V ~ +150 V**
  - **Stiffness in motion direction: 0.16 N/ $\mu\text{m}$**
  - **Resonance frequency(fixed-free): 320 Hz**
    - \*Tolerance value: 250~390 Hz
  - **Blocked force: 120 N** (\*Tolerance value: 90~150N)
  - **Capacitance: 11.5  $\mu\text{F}$**
  - **Dimension: 52x16x16 mm**
  - **Mechanical interface: 2-M3 Tapped hole at both sides**
  - **Environment: 0 to 85°C with humidity less than 40%**
  - **Mass: 48 g**
- \*All dimensions and specifications stated are nominal.

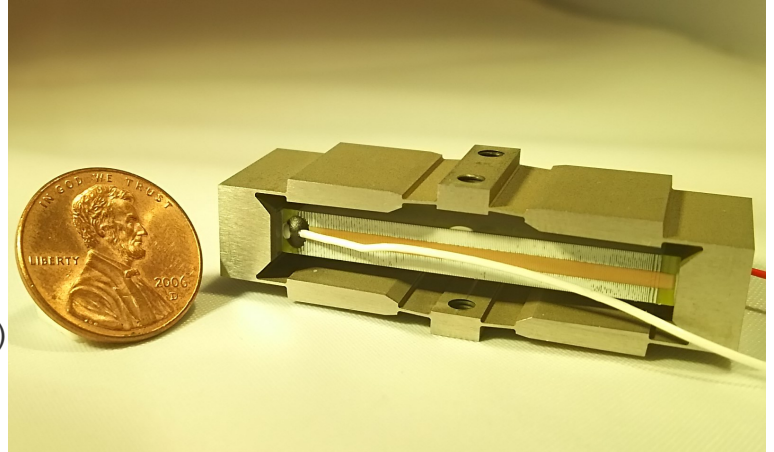

### Option:

- Mechanical interface can be tailor with an addition option fees.

### Geometry

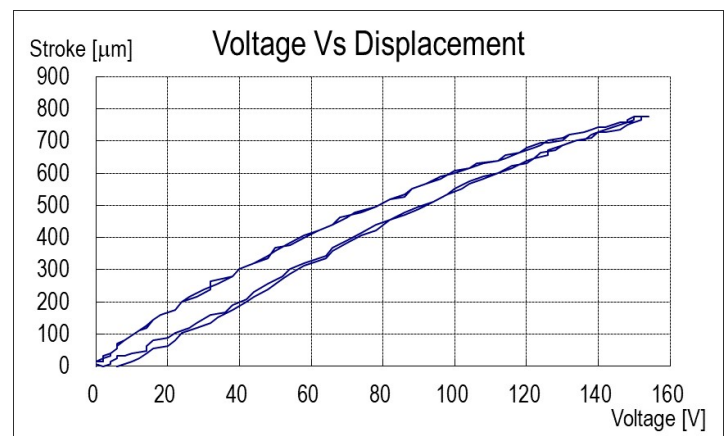
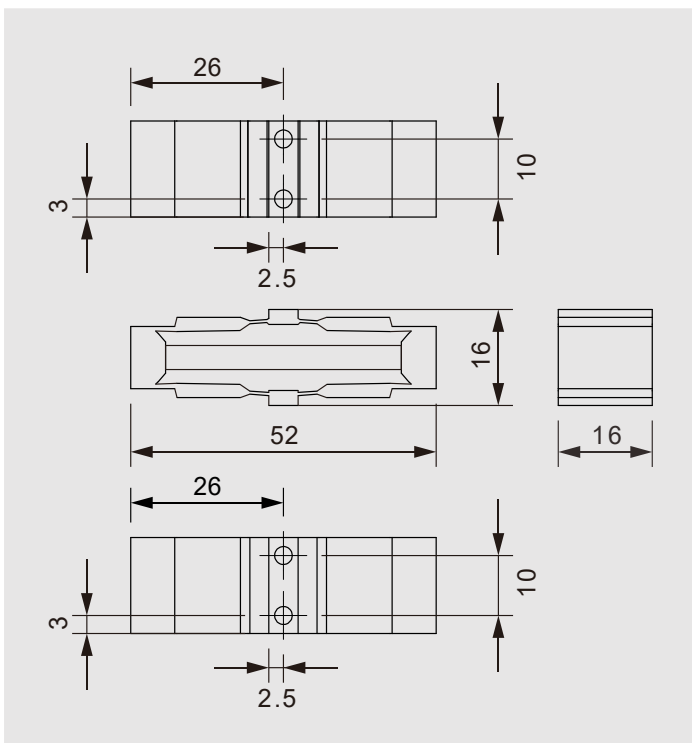

### ANALYZER

2 \*UPPER: 4.5419k LOWER: 8.6739  
0 UPPER: 37.700 LOWER: -103.00

